

# US 41 & Symmes Rd

**CONTACT:**

Name: Christian Yepes

Phone: 727-536-8686

Fax: 727-536-4356

 Email: [christian@belleairgroup.com](mailto:christian@belleairgroup.com)

Hillsborough County, FL

**Property Address:**

 11344 S US 41  
 Gibsonton, FL 33534

**Parcel Size:**

 Approx 1.2 acres on the hard corner  
 Gas station pending on adjacent lot.

**Zoning:**

Commercial (Retail, Fast Food, Bank, etc.)

**Traffic Counts:**

US 41: 32,500 cars per day

**Demographics:**

	Population	Avg. Income
3 miles:	24,400	\$66,600
5 miles:	77,300	\$72,600

**Notes:**

Located at the traffic-lit intersection of US 41 and Symmes Rd, this is a highly visible and easily accessible site. Cross access with the neighboring gas station will allow for convenient ingress and egress for any direction.

[www.belleairgroup.com](http://www.belleairgroup.com)

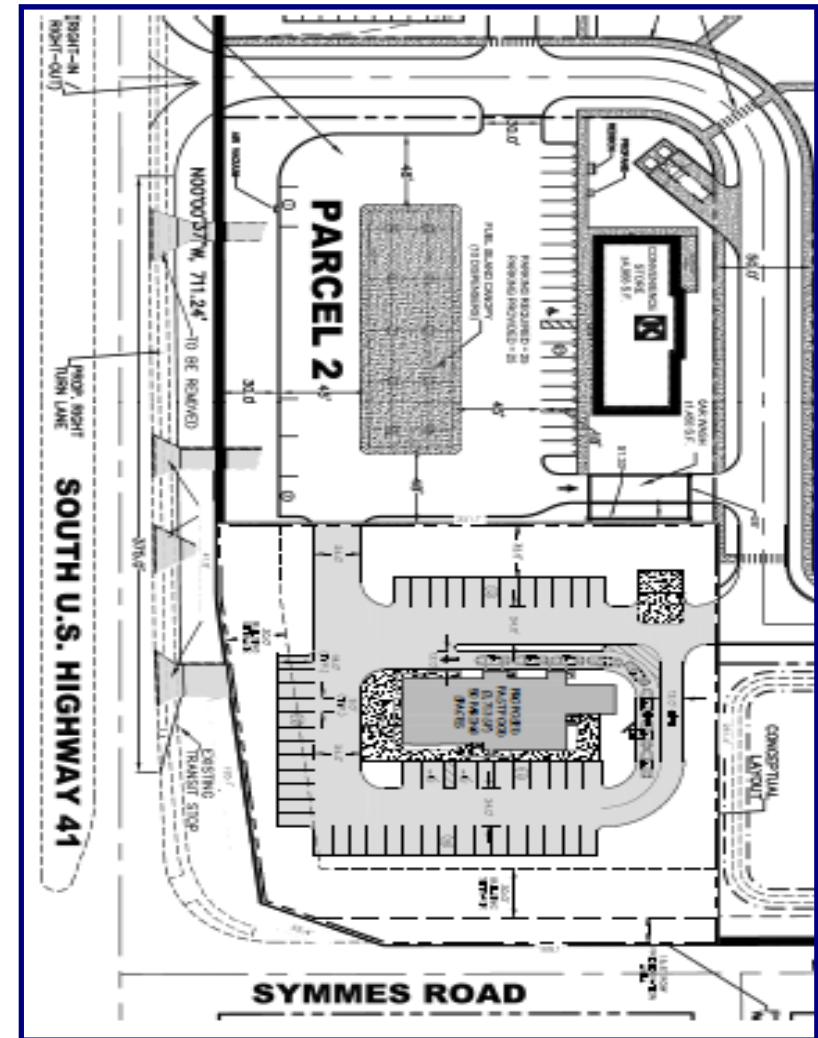

# US 41 & Symmes Rd

**CONTACT:**

Name: Christian Yepes

Phone: 727-536-8686

Fax: 727-536-4356

Email: [christian@belleairgroup.com](mailto:christian@belleairgroup.com)

Hillsborough County, FL

**LOCATION MAP**

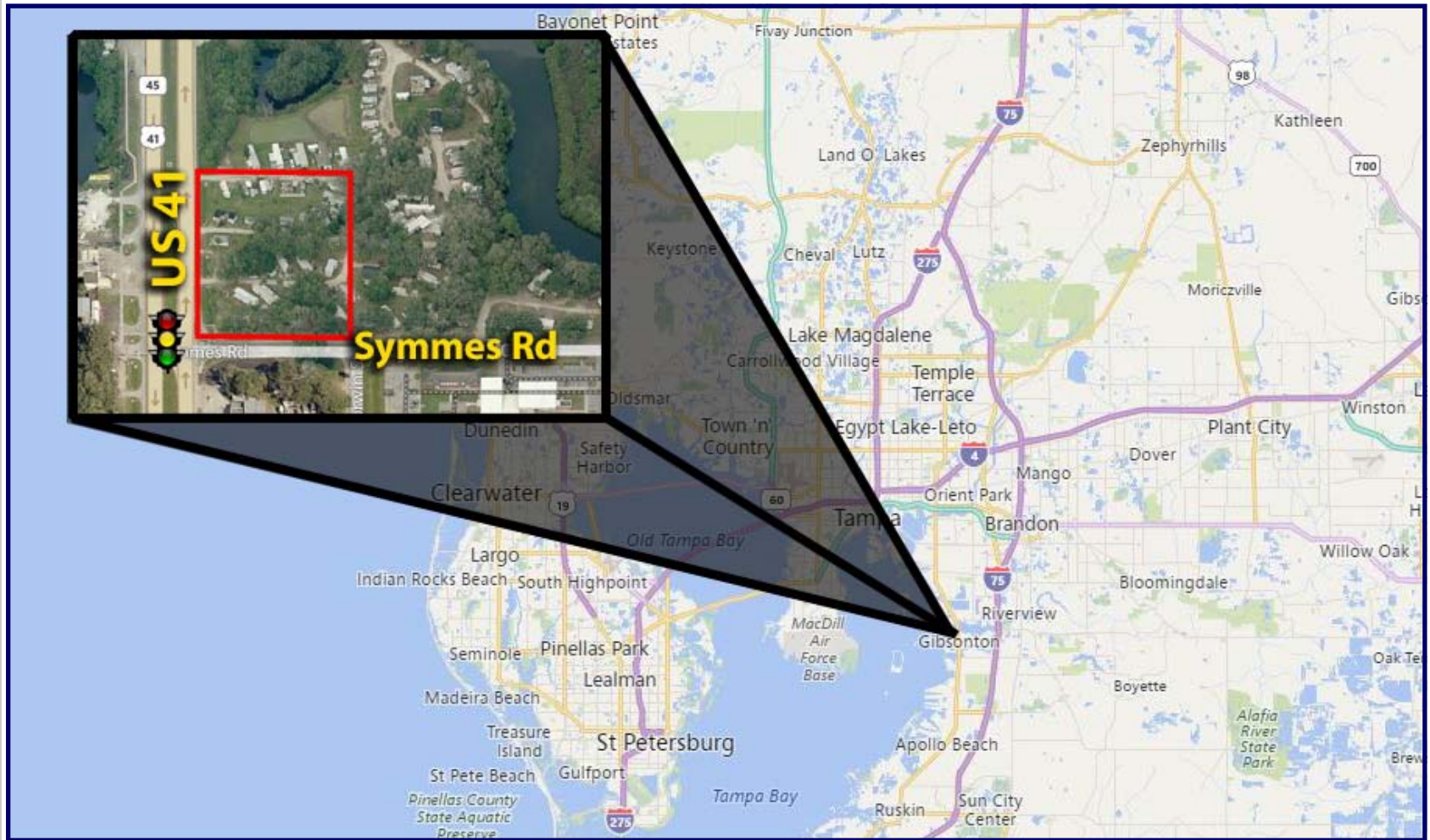



**NEW COMMERCIAL DEVELOPMENT**

11344 S US 41 • GIBSONTON, FL 33534

# US 41 & Symmes Rd

Hillsborough County, FL

**CONTACT:**

Name: Christian Yepes

Phone: 727-536-8686

Fax: 727-536-4356

Email: [christian@belleairgroup.com](mailto:christian@belleairgroup.com)

**BIRD'S EYE VIEW**

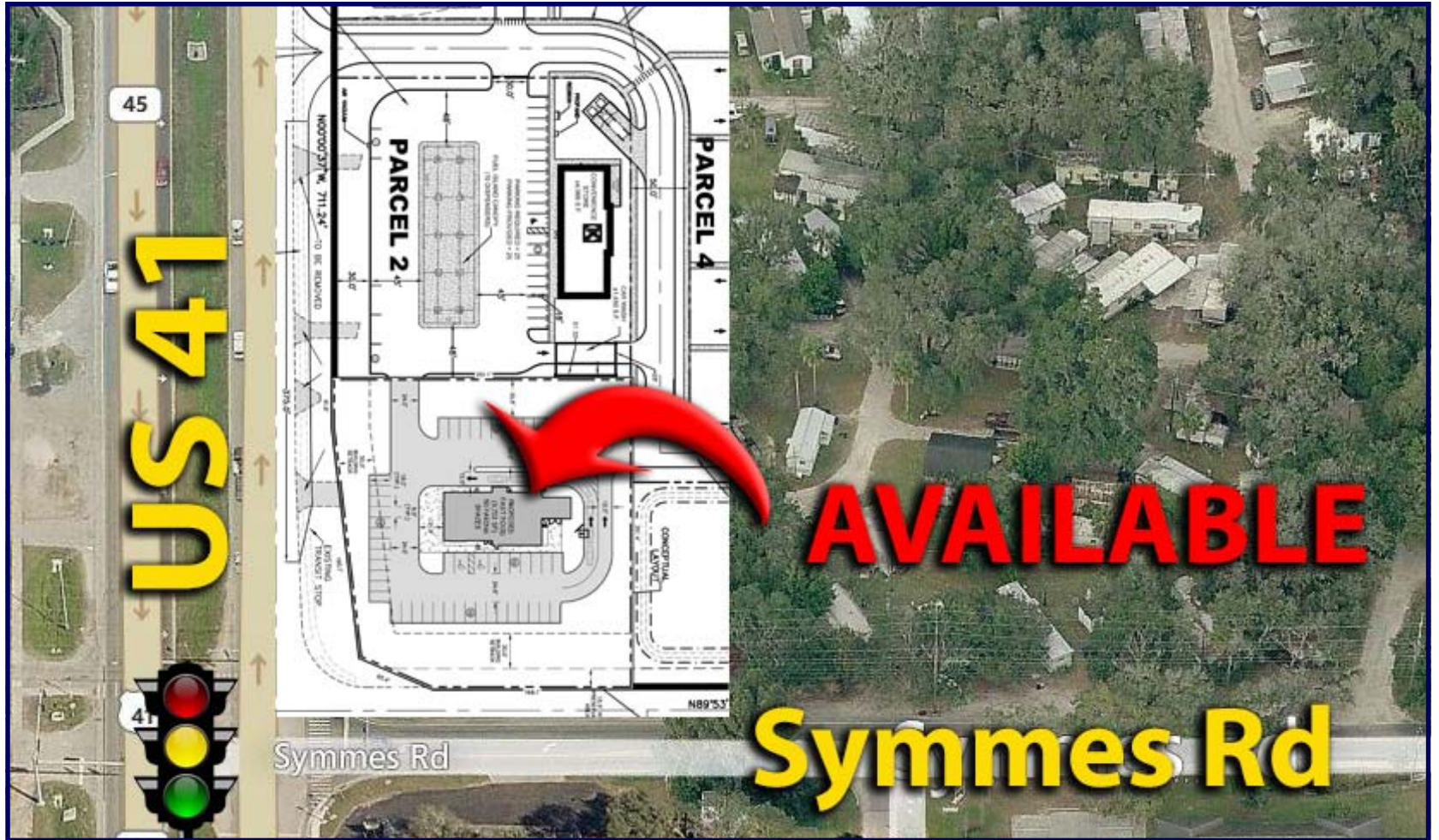

PHONE: 727-536-8686 • FAX: 727-536-4356 • Belleair Development Group